

### Specifications

- Current rating:3A AC,DC
- Voltage rating:250V AC,DC
- Temperature range:-25°C~+85°C
- Contact resistance:20mΩMax.
- Insulation resistance:1000MΩMin.
- Withstanding voltage:1500V AC/minute
- \*Compliant with RoHS and REACH\*
- \*Meet the HF/Halogen Free,need to customize\*
- \*Contact HDGC for details\*

### Assembly layout

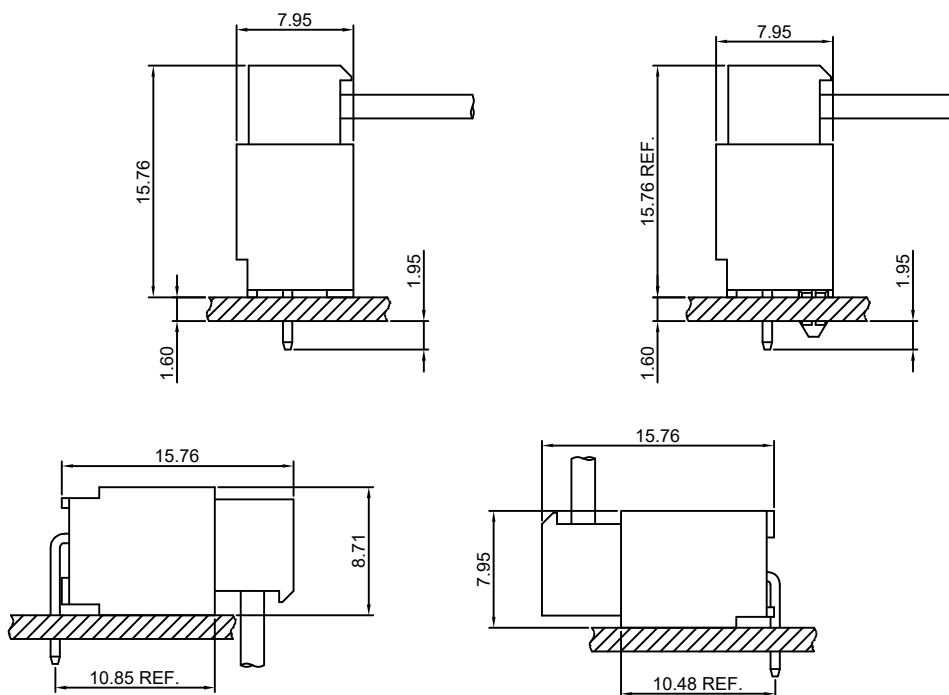



## HDGC2544 Series 2.54mm (.100") Pitch IDC Wire to Board Connector

### HDGC2544H-XP

2.54mm IDC Closed End Type

#### Reference Informations:

\*Material:

Terminal: Phosphor bronze

Housing: Nylon 66, UL94V-2 or UL94V-0

\*Mates with HDGC2544WV, WR, WVA, WRA-XP, HDGC2544WV-F, WVA-F-XP, WR, WRA-XP-2, HDGC2543WVA, WRA-XP series Wafer and HDGC2544L-XP series Covers

#### Ordering Information:

HDGC2544H-XP - \*\* - \*\*  
1 2 3

1: Part No.

2: Material:

RD-Red=22 AWG(UL94V-2)

WH-White=24 AWG(UL94V-2)

BL-Blue=26 AWG(UL94V-2)

GN-Green=28 AWG(UL94V-2)

BK-22-Black=22 AWG(UL94V-0)

BK-24-Black=24 AWG(UL94V-0)

BK-26-Black=26 AWG(UL94V-0)

BK-28-Black=28 AWG(UL94V-0)

3: Plating Code:

(Blank)-Phosphor bronze/Tin over Nickel

GP-Phosphor bronze/Gold over Nickel

(Optional Gold plating available but MOQ requested)

#### Ordering Information & Dimensions:

PART NO.	Dimensions	
	A	B
2P	2.54	5.08
3P	5.08	7.62
4P	7.62	10.16
5P	10.16	12.70
6P	12.70	15.24
7P	15.24	17.78
8P	17.78	20.32
9P	20.32	22.86
10P	22.86	25.40
11P	25.40	27.94
12P	27.94	30.48
13P	30.48	33.02
14P	33.02	35.56
15P	35.56	38.10
16P	38.10	40.64
17P	40.64	43.18
18P	43.18	45.72
19P	45.72	48.26
20P	48.26	50.80
21P	50.80	53.34
22P	53.34	55.88
23P	55.88	58.42
24P	58.42	60.96

Unit: mm

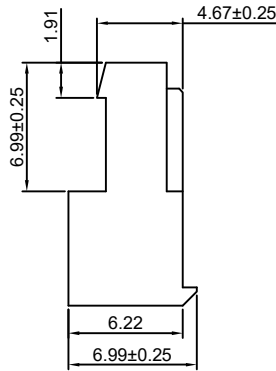
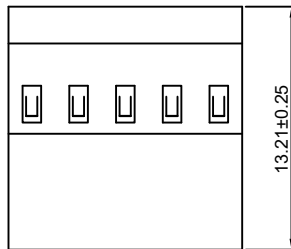
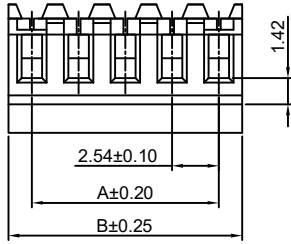

### HDGC2544HA-XP

2.54mm IDC Closed End Type

#### Reference Informations:

\*Material:

Terminal: Phosphor bronze

Housing: Nylon 66, UL94V-2 or UL94V-0

\*Mates with HDGC2544WV, WR, WVA, WRA-XP, HDGC2544WV-F, WVA-F-XP, WR, WRA-XP-2, HDGC2543WVA, WRA-XP series Wafer and HDGC2544L-XP series Covers

#### Ordering Information:

HDGC2544HA-XP - \*\* - \*\*  
1 2 3

1: Part No.

2: Material:

RD-Red=22 AWG(UL94V-2)

WH-White=24 AWG(UL94V-2)

BL-Blue=26 AWG(UL94V-2)

GN-Green=28 AWG(UL94V-2)

BK-22-Black=22 AWG(UL94V-0)

BK-24-Black=24 AWG(UL94V-0)

BK-26-Black=26 AWG(UL94V-0)

BK-28-Black=28 AWG(UL94V-0)

3: Plating Code:

(Blank)-Phosphor bronze/Tin over Nickel

GP-Phosphor bronze/Gold over Nickel

(Optional Gold plating available but MOQ requested)

#### Ordering Information & Dimensions:

PART NO.	Dimensions	
	A	B
2P	2.54	5.08
3P	5.08	7.62
4P	7.62	10.16
5P	10.16	12.70
6P	12.70	15.24
7P	15.24	17.78
8P	17.78	20.32
9P	20.32	22.86
10P	22.86	25.40
11P	25.40	27.94
12P	27.94	30.48
13P	30.48	33.02
14P	33.02	35.56
15P	35.56	38.10
16P	38.10	40.64
17P	40.64	43.18
18P	43.18	45.72
19P	45.72	48.26
20P	48.26	50.80
21P	50.80	53.34
22P	53.34	55.88
23P	55.88	58.42
24P	58.42	60.96

Unit: mm

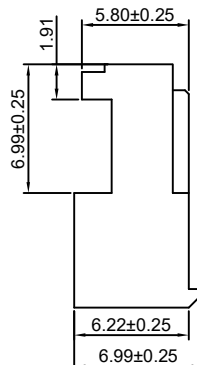
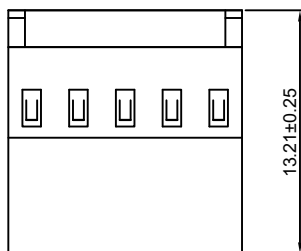
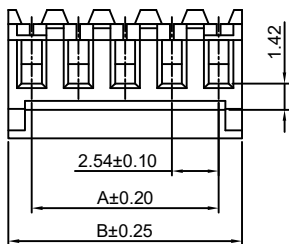



## HDGC2544 Series 2.54mm (.100") Pitch IDC Wire to Board Connector

### HDGC2544HB-XP

2.54mm IDC Feed-Thru Connector

#### Reference Informations:

\*Material:

Terminal: Phosphor bronze

Housing: Nylon 66, UL94V-2 or UL94V-0

\*Mates with HDGC2544WV, WR, WVA, WRA-XP, HDGC2544WV-F, WVA-F-XP, WR, WRA-XP-2, HDGC2543WVA, WRA-XP series Wafer and HDGC2544C-XP series Covers

Ordering Information:

HDGC2544HB-XP - \*\* - \*\*  
1 2 3

1: Part No.

2: Material:

RD-Red=22 AWG(UL94V-2)

WH-White=24 AWG(UL94V-2)

BL-Blue=26 AWG(UL94V-2)

GN-Green=28 AWG(UL94V-2)

BK-22-Black=22 AWG(UL94V-0)

BK-24-Black=24 AWG(UL94V-0)

BK-26-Black=26 AWG(UL94V-0)

BK-28-Black=28 AWG(UL94V-0)

3: Plating Code:

(Blank)-Phosphor bronze/Tin over Nickel

GP-Phosphor bronze/Gold over Nickel

(Optional Gold plating available but MOQ requested)

#### Ordering Information & Dimensions:

PART NO.	Dimensions	
	A	B
2P	2.54	5.08
3P	5.08	7.62
4P	7.62	10.16
5P	10.16	12.70
6P	12.70	15.24
7P	15.24	17.78
8P	17.78	20.32
9P	20.32	22.86
10P	22.86	25.40
11P	25.40	27.94
12P	27.94	30.48
13P	30.48	33.02
14P	33.02	35.56
15P	35.56	38.10
16P	38.10	40.64
17P	40.64	43.18
18P	43.18	45.72
19P	45.72	48.26
20P	48.26	50.80
21P	50.80	53.34
22P	53.34	55.88
23P	55.88	58.42
24P	58.42	60.96

Unit: mm

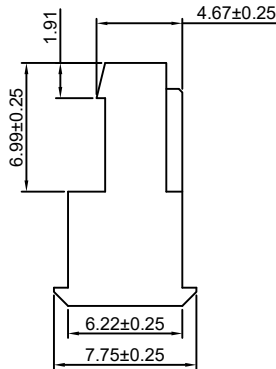
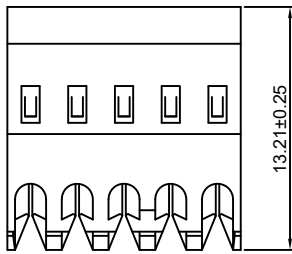
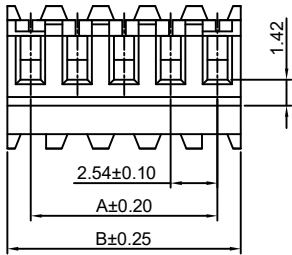

### HDGC2544HC-XP

2.54mm IDC Feed-Thru Connector

#### Reference Informations:

\*Material:

Terminal: Phosphor bronze

Housing: Nylon 66, UL94V-2 or UL94V-0

\*Mates with HDGC2544WV, WR, WVA, WRA-XP, HDGC2544WV-F, WVA-F-XP, WR, WRA-XP-2, HDGC2543WVA, WRA-XP series Wafer and HDGC2544C-XP series Covers

Ordering Information:

HDGC2544HC-XP - \*\* - \*\*  
1 2 3

1: Part No.

2: Material:

RD-Red=22 AWG(UL94V-2)

WH-White=24 AWG(UL94V-2)

BL-Blue=26 AWG(UL94V-2)

GN-Green=28 AWG(UL94V-2)

BK-22-Black=22 AWG(UL94V-0)

BK-24-Black=24 AWG(UL94V-0)

BK-26-Black=26 AWG(UL94V-0)

BK-28-Black=28 AWG(UL94V-0)

3: Plating Code:

(Blank)-Phosphor bronze/Tin over Nickel

GP-Phosphor bronze/Gold over Nickel

(Optional Gold plating available but MOQ requested)

#### Ordering Information & Dimensions:

PART NO.	Dimensions	
	A	B
2P	2.54	5.08
3P	5.08	7.62
4P	7.62	10.16
5P	10.16	12.70
6P	12.70	15.24
7P	15.24	17.78
8P	17.78	20.32
9P	20.32	22.86
10P	22.86	25.40
11P	25.40	27.94
12P	27.94	30.48
13P	30.48	33.02
14P	33.02	35.56
15P	35.56	38.10
16P	38.10	40.64
17P	40.64	43.18
18P	43.18	45.72
19P	45.72	48.26
20P	48.26	50.80
21P	50.80	53.34
22P	53.34	55.88
23P	55.88	58.42
24P	58.42	60.96

Unit: mm

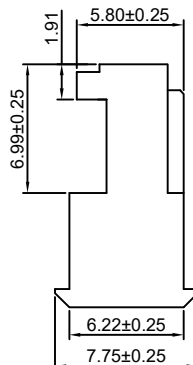
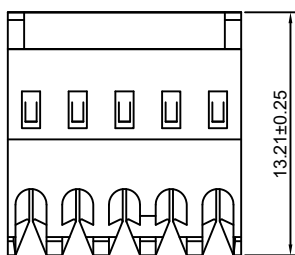
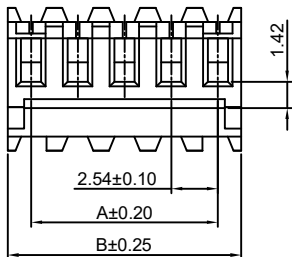



## HDGC2544 Series 2.54mm (.100") Pitch IDC Wire to Board Connector

### HDGC2544HD-XP

2.54mm IDC Closed End IDC Connector

#### Reference Informations:

##### \*Material:

Terminal: Phosphor bronze

Housing: Nylon 66, UL94V-2 or UL94V-0

\*Mates with HDGC2544WV, WR-XP, WV-F-XP, HDGC2544WR-XP-2, HDGC2543WVA, WRA-XP series Wafer and HDGC2544L-XP series Covers

##### Ordering Information:

HDGC2544HD-XP - \*\* - \*\*  
1 2 3

1: Part No.

2: Wire Range and Material:

2-22 AWG (UL94V-2)

4-24 AWG (UL94V-2)

6-26 AWG (UL94V-2)

8-28 AWG (UL94V-2)

3: Plating Code:

(Blank)-Phosphor bronze/Tin over Nickel

GP-Phosphor bronze/Gold over Nickel

(Optional Gold plating available but MOQ requested)

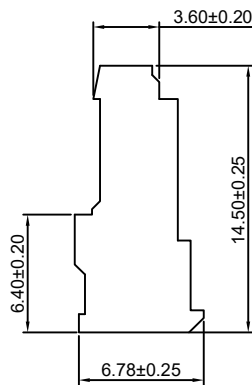
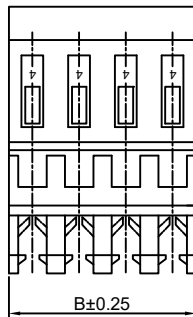
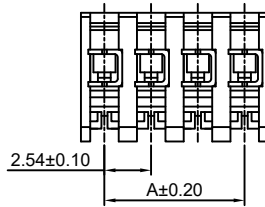

#### Ordering Information & Dimensions:

PART NO.	Dimensions	
	A	B
2P	2.54	5.08
3P	5.08	7.62
4P	7.62	10.16
5P	10.16	12.70
6P	12.70	15.24
7P	15.24	17.78
8P	17.78	20.32
9P	20.32	22.86
10P	22.86	25.40
11P	25.40	27.94
12P	27.94	30.48
13P	30.48	33.02
14P	33.02	35.56
15P	35.56	38.10
16P	38.10	40.64
17P	40.64	43.18

Unit: mm

### HDGC2544HE-XP

2.54mm IDC Closed End IDC Connector

#### Reference Informations:

##### \*Material:

Terminal: Phosphor bronze

Housing: Nylon 66, UL94V-2 or UL94V-0

\*Mates with HDGC2544WV, WR-XP, WV-F-XP, HDGC2544WR-XP-2, HDGC2543WVA, WRA-XP series Wafer and HDGC2544L-XP series Covers

##### Ordering Information:

HDGC2544HE-XP - \*\* - \*\*  
1 2 3

1: Part No.

2: Wire Range and Material:

2-22 AWG (UL94V-2)

4-24 AWG (UL94V-2)

6-26 AWG (UL94V-2)

8-28 AWG (UL94V-2)

3: Plating Code:

(Blank)-Phosphor bronze/Tin over Nickel

GP-Phosphor bronze/Gold over Nickel

(Optional Gold plating available but MOQ requested)

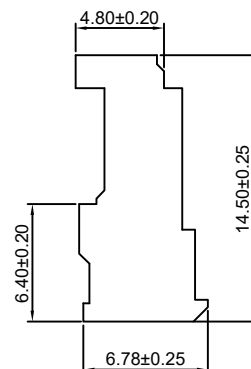
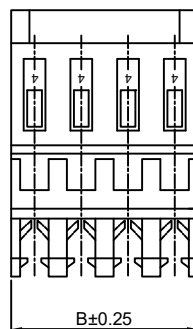
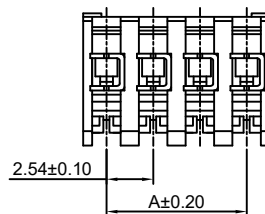

#### Ordering Information & Dimensions:

PART NO.	Dimensions	
	A	B
2P	2.54	5.08
3P	5.08	7.62
4P	7.62	10.16
5P	10.16	12.70
6P	12.70	15.24
7P	15.24	17.78
8P	17.78	20.32
9P	20.32	22.86
10P	22.86	25.40
11P	25.40	27.94
12P	27.94	30.48
13P	30.48	33.02
14P	33.02	35.56
15P	35.56	38.10
16P	38.10	40.64
17P	40.64	43.18

Unit: mm



## HDGC2544 Series 2.54mm (.100") Pitch IDC Wire to Board Connector

### HDGC2544HF-XP

2.54mm IDC Closed End IDC Connector

#### Reference Informations:

\*Material:

Terminal: Phosphor bronze

Housing: Nylon 66, UL94V-2 or UL94V-0

\*Mates with HDGC2544WV, WR-XP, WV-F-XP, HDGC2544WR-XP-2, HDGC2543WVA, WRA-XP series Wafer and HDGC2544C-XP series Covers

Ordering Information:

HDGC2544HF-XP - \*\* - \*\*  
1 2 3

1: Part No.

2: Wire Range and Material:

2-22 AWG (UL94V-2)

4-24 AWG (UL94V-2)

6-26 AWG (UL94V-2)

8-28 AWG (UL94V-2)

3: Plating Code:

(Blank)-Phosphor bronze/Tin over Nickel

GP-Phosphor bronze/Gold over Nickel

(Optional Gold plating available but MOQ requested)

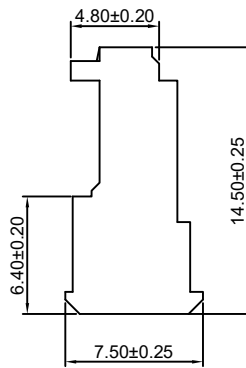
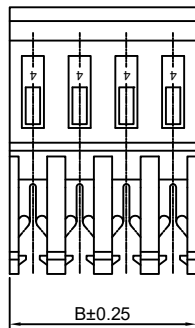
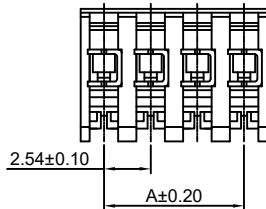

#### Ordering Information & Dimensions:

PART NO.	Dimensions	
	A	B
2P	2.54	5.08
3P	5.08	7.62
4P	7.62	10.16
5P	10.16	12.70
6P	12.70	15.24
7P	15.24	17.78
8P	17.78	20.32
9P	20.32	22.86
10P	22.86	25.40
11P	25.40	27.94
12P	27.94	30.48
13P	30.48	33.02
14P	33.02	35.56
15P	35.56	38.10
16P	38.10	40.64
17P	40.64	43.18

Unit: mm

### HDGC2544HG-XP

2.54mm IDC Closed End IDC Connector

#### Reference Informations:

\*Material:

Terminal: Phosphor bronze

Housing: Nylon 66, UL94V-2 or UL94V-0

\*Mates with HDGC2544WV, WR-XP, WV-F-XP, HDGC2544WR-XP-2, HDGC2543WVA, WRA-XP series Wafer and HDGC2544C-XP series Covers

Ordering Information:

HDGC2544HG-XP - \*\* - \*\*  
1 2 3

1: Part No.

2: Wire Range and Material:

2-22 AWG (UL94V-2)

4-24 AWG (UL94V-2)

6-26 AWG (UL94V-2)

8-28 AWG (UL94V-2)

3: Plating Code:

(Blank)-Phosphor bronze/Tin over Nickel

GP-Phosphor bronze/Gold over Nickel

(Optional Gold plating available but MOQ requested)

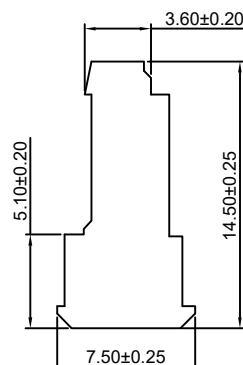
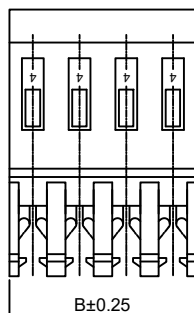
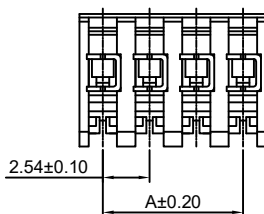

#### Ordering Information & Dimensions:

PART NO.	Dimensions	
	A	B
2P	2.54	5.08
3P	5.08	7.62
4P	7.62	10.16
5P	10.16	12.70
6P	12.70	15.24
7P	15.24	17.78
8P	17.78	20.32
9P	20.32	22.86
10P	22.86	25.40
11P	25.40	27.94
12P	27.94	30.48
13P	30.48	33.02
14P	33.02	35.56
15P	35.56	38.10
16P	38.10	40.64
17P	40.64	43.18

Unit: mm



## HDGC2544 Series 2.54mm (.100") Pitch IDC Wire to Board Connector

### HDGC2544WV-XP

2.54mm IDC 180° Wafer

**Reference Informations:**

- \*Material:Pin:Brass/Tin over Nickel  
Insulator:Nylon 46,UL94V-0
- \*Mates with HDGC2544H,HA,HB,HC,HD,HE,HF,HG-XP series Housing
- \*Color:Black

**Ordering Information:**

- HDGC2544WV-XP - \*\*\* - \*\*\*  
1 2 3
- 1.Part No.
  - 2.Material:  
(blank):Nylon 46,UL94V-0  
GWT:Nylon 46,UL94V-0,GWT 750°C
  - 3.Finish:  
(blank):Tin over Nickel  
G:Gold-flash  
G30:30µin (0.76µm) MIN.Select Gold(Mating Area)  
100µin (2.54µm) MIN.Select Tin

**Ordering Information & Dimensions:**

PART NO.	Dimensions	
	A	B
2P	2.54	7.21
3P	5.08	9.75
4P	7.62	12.29
5P	10.16	14.83
6P	12.70	17.37
7P	15.24	19.91
8P	17.78	22.45
9P	20.32	24.99
10P	22.86	27.53
11P	25.40	30.07
12P	27.94	32.61
13P	30.48	35.15
14P	33.02	37.69
15P	35.56	40.23
16P	38.10	42.77
17P	40.64	45.31
18P	43.18	47.85
19P	45.72	50.39
20P	48.26	52.93
21P	50.80	55.47
22P	53.34	58.01
23P	55.88	60.55
24P	58.42	63.09

Unit: mm

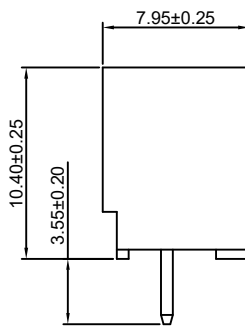
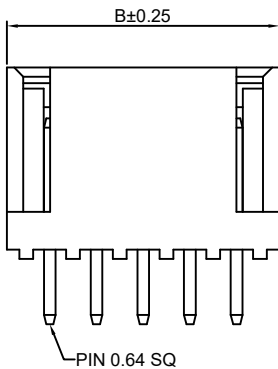
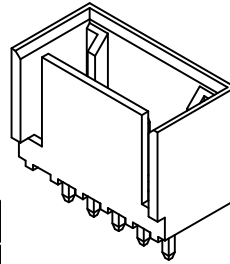
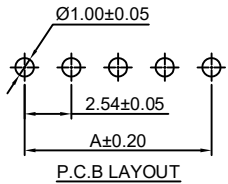
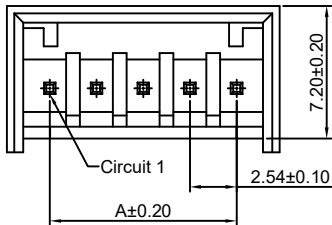

### HDGC2544WV-F-XP

2.54mm IDC 180° Wafer

**Reference Informations:**

- \*Material:Pin:Brass/Tin over Nickel  
Insulator:Nylon 46,UL94V-0
- \*Mates with HDGC2544H,HA,HB,HC,HD,HE,HF,HG-XP series Housing
- \*Color:Black

**Ordering Information:**

- HDGC2544WV-F-XP - \*\*\* - \*\*\*  
1 2 3
- 1.Part No.
  - 2.Material:  
(blank):Nylon 46,UL94V-0  
GWT:Nylon 46,UL94V-0,GWT 750°C
  - 3.Finish:  
(blank):Tin over Nickel  
G:Gold-flash  
G30:30µin (0.76µm) MIN.Select Gold(Mating Area)  
100µin (2.54µm) MIN.Select Tin

**Ordering Information & Dimensions:**

PART NO.	Dimensions	
	A	B
2P	2.54	7.21
3P	5.08	9.75
4P	7.62	12.29
5P	10.16	14.83
6P	12.70	17.37
7P	15.24	19.91
8P	17.78	22.45
9P	20.32	24.99
10P	22.86	27.53
11P	25.40	30.07
12P	27.94	32.61
13P	30.48	35.15
14P	33.02	37.69
15P	35.56	40.23
16P	38.10	42.77
17P	40.64	45.31
18P	43.18	47.85
19P	45.72	50.39
20P	48.26	52.93
21P	50.80	55.47
22P	53.34	58.01
23P	55.88	60.55
24P	58.42	63.09

Unit: mm

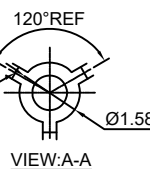
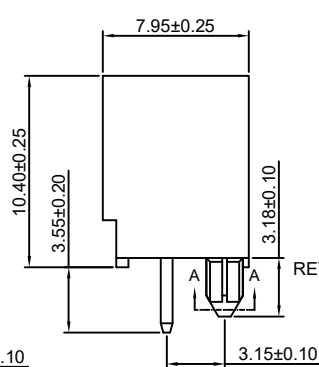
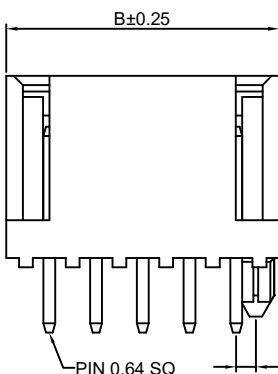
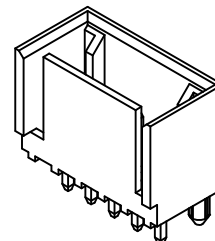
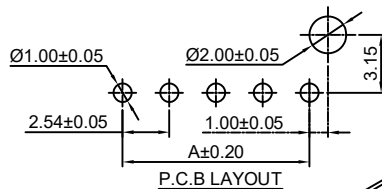
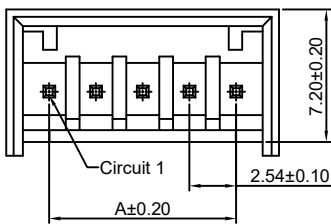



## HDGC2544 Series 2.54mm (.100") Pitch IDC Wire to Board Connector

### HDGC2544WR-XP

2.54mm IDC 90° Wafer

**Reference Informations:**

- \*Material: Pin: Brass/Tin over Nickel  
Insulator: Nylon 46, UL94V-0
- \*Mates with HDGC2544H, HA, HB, HC, HD, HE, HF, HG-XP series Housing
- \*Color: Black

**Ordering Information:**

HDGC2544WR-XP - \*\*\* - \*\*\*  
1 2 3

1. Part No.
2. Material:  
(blank): Nylon 46, UL94V-0  
G: Gold-flash  
G30: 30µin (0.76µm) MIN. Select Gold (Mating Area)  
100µin (2.54µm) MIN. Select Tin
3. Finish:  
(blank): Tin over Nickel  
G: Gold-flash  
G30: 30µin (0.76µm) MIN. Select Gold (Mating Area)  
100µin (2.54µm) MIN. Select Tin

**Ordering Information & Dimensions:**

PART NO.	Dimensions	
	A	B
2P	2.54	7.21
3P	5.08	9.75
4P	7.62	12.29
5P	10.16	14.83
6P	12.70	17.37
7P	15.24	19.91
8P	17.78	22.45
9P	20.32	24.99
10P	22.86	27.53
11P	25.40	30.07
12P	27.94	32.61
13P	30.48	35.15
14P	33.02	37.69
15P	35.56	40.23
16P	38.10	42.77
17P	40.64	45.31
18P	43.18	47.85
19P	45.72	50.39
20P	48.26	52.93
21P	50.80	55.47
22P	53.34	58.01
23P	55.88	60.55
24P	58.42	63.09

Unit: mm

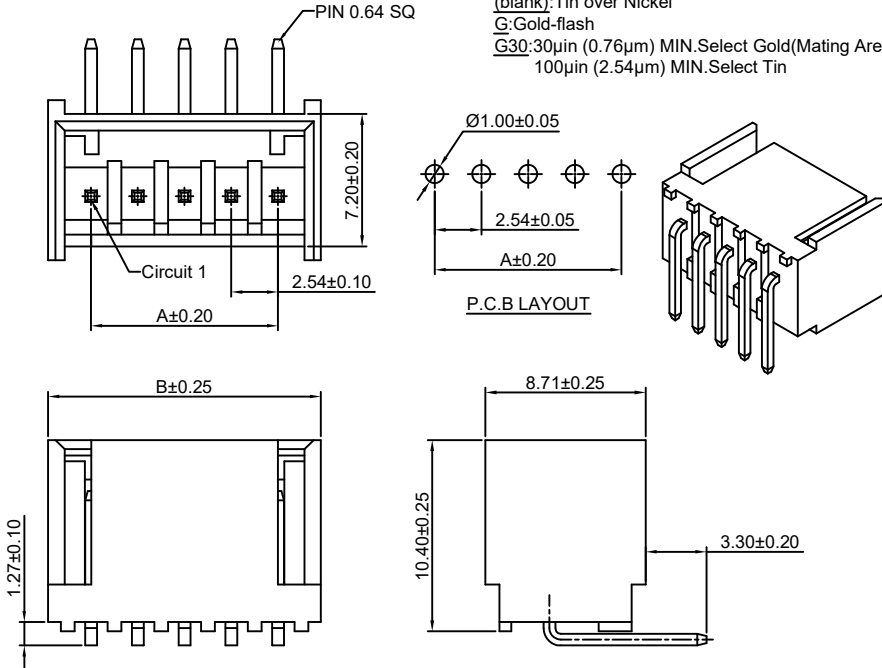

### HDGC2544WR-XP-2

2.54mm IDC 90° Wafer

**Reference Informations:**

- \*Material: Pin: Brass/Tin over Nickel  
Insulator: Nylon 46, UL94V-0
- \*Mates with HDGC2544H, HA, HB, HC, HD, HE, HF, HG-XP series Housing
- \*Color: Black

**Ordering Information:**

HDGC2544WR-XP-2 - \*\*\* - \*\*\*  
1 2 3

1. Part No.
2. Material:  
(blank): Nylon 46, UL94V-0  
G: Gold-flash  
G30: 30µin (0.76µm) MIN. Select Gold (Mating Area)  
100µin (2.54µm) MIN. Select Tin
3. Finish:  
(blank): Tin over Nickel  
G: Gold-flash  
G30: 30µin (0.76µm) MIN. Select Gold (Mating Area)  
100µin (2.54µm) MIN. Select Tin

**Ordering Information & Dimensions:**

PART NO.	Dimensions	
	A	B
2P	2.54	7.21
3P	5.08	9.75
4P	7.62	12.29
5P	10.16	14.83
6P	12.70	17.37
7P	15.24	19.91
8P	17.78	22.45
9P	20.32	24.99
10P	22.86	27.53
11P	25.40	30.07
12P	27.94	32.61
13P	30.48	35.15
14P	33.02	37.69
15P	35.56	40.23
16P	38.10	42.77
17P	40.64	45.31
18P	43.18	47.85
19P	45.72	50.39
20P	48.26	52.93
21P	50.80	55.47
22P	53.34	58.01
23P	55.88	60.55
24P	58.42	63.09

Unit: mm

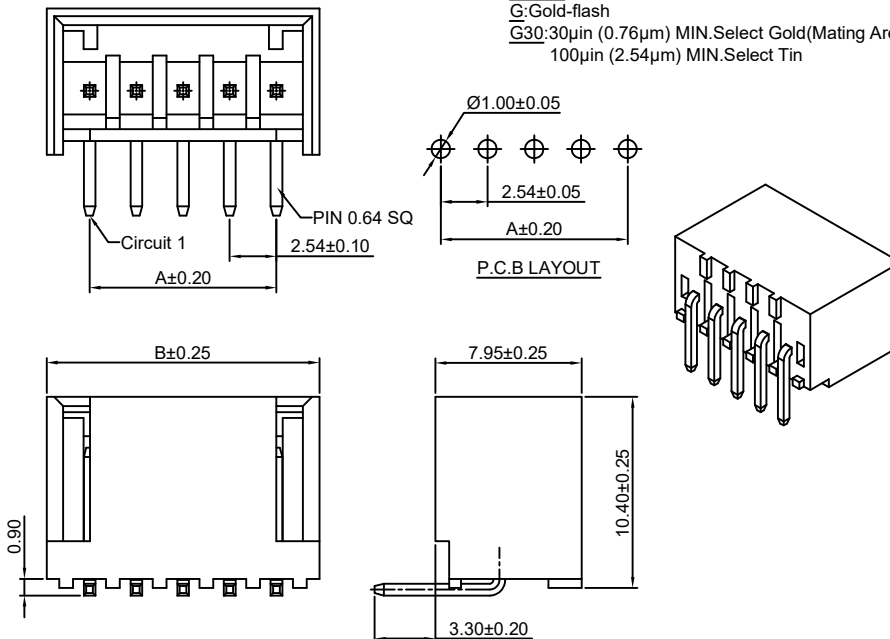





## HDGC2544 Series 2.54mm (.100") Pitch IDC Wire to Board Connector

### HDGC2544WVA-XP

2.54mm IDC 180° Wafer

**Reference Informations:**

- \*Material:Pin:Brass/Tin over Nickel  
Insulator:Nylon 46,UL94V-0
- \*Mates with HDGC2544H,HA,HB,HC-XP,  
HDGC2543HA(HB)-XP-WH series Housing
- \*Color:Black

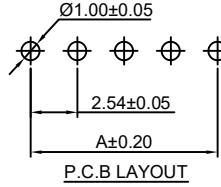
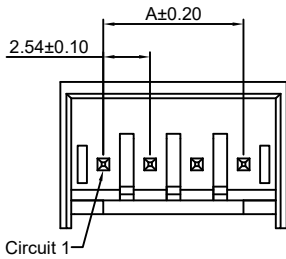

Ordering Information:  
HDGC2544WVA-XP - <sup>\*\*\*</sup>/<sub>2</sub> - <sup>\*\*\*</sup>/<sub>3</sub>

- 1.Part No.
- 2.Material:  
(blank):Nylon 46,UL94V-0  
GWT:Nylon 46,UL94V-0,GWT 750°C
- 3.Finish:  
(Blank):Brass/Tin over Nickel  
G:Brass/Gold over Nickel(1u")  
G30:Brass/Gold over Nickel(30u")

**Ordering Information & Dimensions:**

PART NO.	Dimensions	
	A	B
2P	2.54	7.21
3P	5.08	9.75
4P	7.62	12.29
5P	10.16	14.83
6P	12.70	17.37
7P	15.24	19.91
8P	17.78	22.45
9P	20.32	24.99
10P	22.86	27.53
11P	25.40	30.07
12P	27.94	32.61
13P	30.48	35.15
14P	33.02	37.69
15P	35.56	40.23
16P	38.10	42.77
17P	40.64	45.31
18P	43.18	47.85
19P	45.72	50.39
20P	48.26	52.93
21P	50.80	55.47
22P	53.34	58.01
23P	55.88	60.55
24P	58.42	63.09

Unit: mm

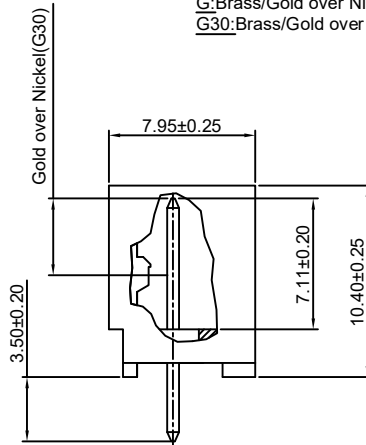
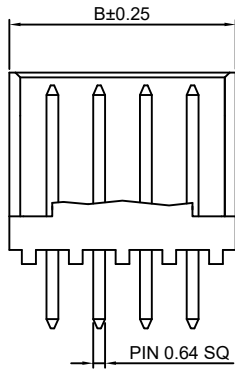

### HDGC2544WVA-F-XP

2.54mm IDC 180° Wafer

**Reference Informations:**

- \*Material:Pin:Brass/Tin over Nickel  
Insulator:Nylon 46,UL94V-0
- \*Mates with HDGC2544H,HA,HB,HC-XP,  
HDGC2543HA(HB)-XP-WH series Housing
- \*Color:Black

Ordering Information:  
HDGC2544WVA-F-XP - <sup>\*\*\*</sup>/<sub>2</sub> - <sup>\*\*\*</sup>/<sub>3</sub>

- 1.Part No.
- 2.Material:  
(blank):Nylon 46,UL94V-0  
GWT:Nylon 46,UL94V-0,GWT 750°C
- 3.Finish:  
(Blank):Brass/Tin over Nickel  
G:Brass/Gold over Nickel(1u")  
G30:Brass/Gold over Nickel(30u")

**Ordering Information & Dimensions:**

PART NO.	Dimensions	
	A	B
2P	2.54	7.21
3P	5.08	9.75
4P	7.62	12.29
5P	10.16	14.83
6P	12.70	17.37
7P	15.24	19.91
8P	17.78	22.45
9P	20.32	24.99
10P	22.86	27.53
11P	25.40	30.07
12P	27.94	32.61
13P	30.48	35.15
14P	33.02	37.69
15P	35.56	40.23
16P	38.10	42.77
17P	40.64	45.31
18P	43.18	47.85
19P	45.72	50.39
20P	48.26	52.93
21P	50.80	55.47
22P	53.34	58.01
23P	55.88	60.55
24P	58.42	63.09

Unit: mm

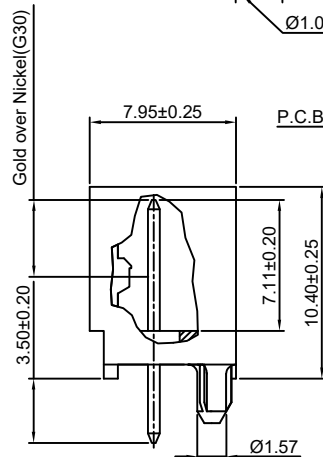
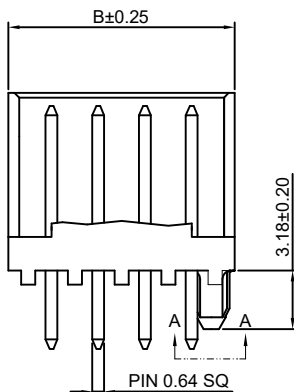
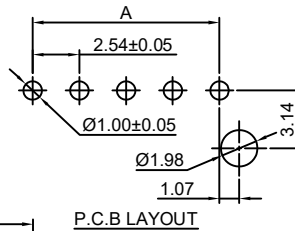
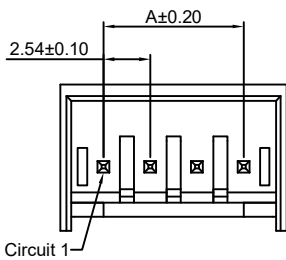





## HDGC2544 Series 2.54mm (.100") Pitch IDC Wire to Board Connector

### HDGC2544WRA-XP

2.54mm IDC 90° Wafer

**Reference Informations:**

- \*Material:Pin:Brass/Tin over Nickel  
Insulator:Nylon 46,UL94V-0
- \*Mates with HDGC2544H,HA,HB,HC-XP,  
HDGC2543HA(HB)-XP-WH series Housing
- \*Color:Black

Ordering Information:  
**HDGC2544WRA-XP** - \*\*\* - \*\*\*  
 1 2 3

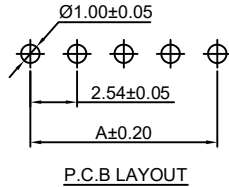
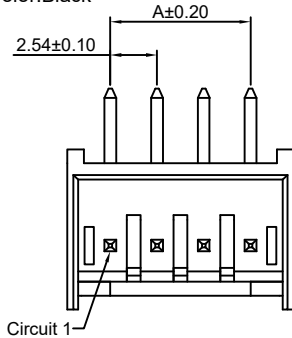

- 1.Part No.
- 2.Material:  
(blank):Nylon 46,UL94V-0  
GWT:Nylon 46,UL94V-0,GWT 750°C
- 3.Finish:  
(Blank):Brass/Tin over Nickel  
G:Brass/Gold over Nickel(1u")  
G30:Brass/Gold over Nickel(30u")

**Ordering Information & Dimensions:**

PART NO.	Dimensions	
	A	B
2P	2.54	7.21
3P	5.08	9.75
4P	7.62	12.29
5P	10.16	14.83
6P	12.70	17.37
7P	15.24	19.91
8P	17.78	22.45
9P	20.32	24.99
10P	22.86	27.53
11P	25.40	30.07
12P	27.94	32.61
13P	30.48	35.15
14P	33.02	37.69
15P	35.56	40.23
16P	38.10	42.77
17P	40.64	45.31
18P	43.18	47.85
19P	45.72	50.39
20P	48.26	52.93
21P	50.80	55.47
22P	53.34	58.01
23P	55.88	60.55
24P	58.42	63.09

Unit: mm

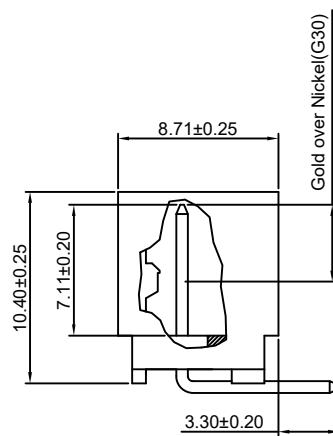
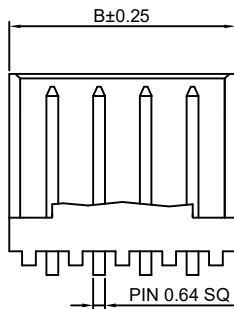

### HDGC2544WRA-XP-2

2.54mm IDC 90° Wafer

**Reference Informations:**

- \*Material:Pin:Brass/Tin over Nickel  
Insulator:Nylon 46,UL94V-0
- \*Mates with HDGC2544H,HA,HB,HC-XP,  
HDGC2543HA(HB)-XP-WH series Housing
- \*Color:Black

Ordering Information:  
**HDGC2544WRA-XP-2** - \*\*\* - \*\*\*  
 1 2 3

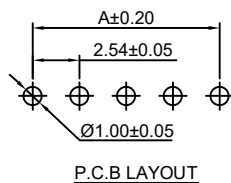
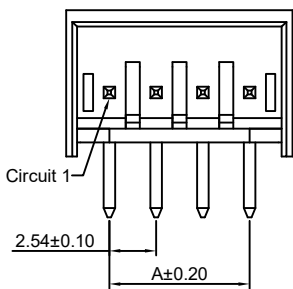

- 1.Part No.
- 2.Material:  
(blank):Nylon 46,UL94V-0  
GWT:Nylon 46,UL94V-0,GWT 750°C
- 3.Finish:  
(Blank):Brass/Tin over Nickel  
G:Brass/Gold over Nickel(1u")  
G30:Brass/Gold over Nickel(30u")

**Ordering Information & Dimensions:**

PART NO.	Dimensions	
	A	B
2P	2.54	7.21
3P	5.08	9.75
4P	7.62	12.29
5P	10.16	14.83
6P	12.70	17.37
7P	15.24	19.91
8P	17.78	22.45
9P	20.32	24.99
10P	22.86	27.53
11P	25.40	30.07
12P	27.94	32.61
13P	30.48	35.15
14P	33.02	37.69
15P	35.56	40.23
16P	38.10	42.77
17P	40.64	45.31
18P	43.18	47.85
19P	45.72	50.39
20P	48.26	52.93
21P	50.80	55.47
22P	53.34	58.01
23P	55.88	60.55
24P	58.42	63.09

Unit: mm

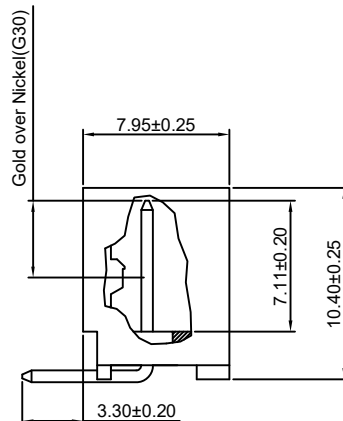
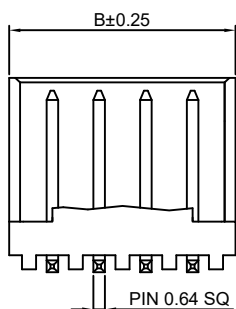



## HDGC2544 Series 2.54mm (.100") Pitch IDC Wire to Board Connector

### HDGC2544C-XP

2.54mm Feed-Thru Strain Relief Covers

**Reference Informations:**

- \*Material:Nylon 66,UL94V-2
- \*Mates with HDGC2544HB,HC, HF,HG-XP series Housing
- \*Color:Natural(White)

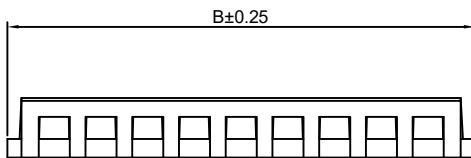
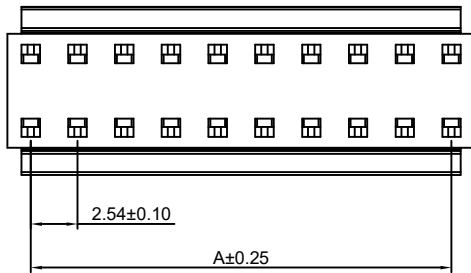

Ordering Information:  
HDGC2544C-XP - \*\*\*  
 1 2

- 1.Part No.
- 2:Material:  
 (blank):Nylon 66,UL94V-2  
 GWT:Nylon 66,UL94V-0,GWT 750°C

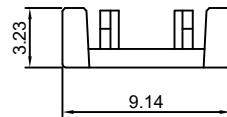

Ordering Information & Dimensions:

PART NO.	Dimensions	
	A	B
2P	2.54	5.08
3P	5.08	7.62
4P	7.62	10.16
5P	10.16	12.70
6P	12.70	15.24
7P	15.24	17.78
8P	17.78	20.32
9P	20.32	22.86
10P	22.86	25.40
11P	25.40	27.94
12P	27.94	30.48
13P	30.48	33.02
14P	33.02	35.56
15P	35.56	38.10
16P	38.10	40.64
17P	40.64	43.18
18P	43.18	45.72
19P	45.72	48.26
20P	48.26	50.80
21P	50.80	53.34
22P	53.34	55.88
23P	55.88	58.42
24P	58.42	60.96

Unit: mm

### HDGC2544L-XP

2.54mm IDC Closed End Strain Relief Covers

**Reference Informations:**

- \*Material:Nylon 66,UL94V-2
- \*Mates with HDGC2544H,HA, HD,HE-XP series Housing
- \*Color:Natural(White)

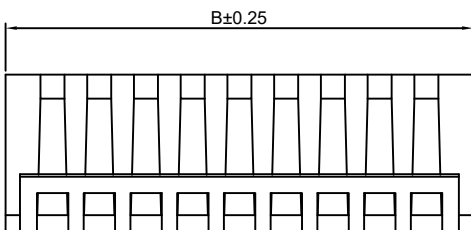
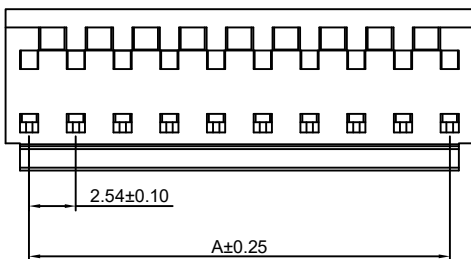

Ordering Information:  
HDGC2544L-XP - \*\*\*  
 1 2

- 1.Part No.
- 2:Material:  
 (blank):Nylon 66,UL94V-2  
 GWT:Nylon 66,UL94V-0,GWT 750°C

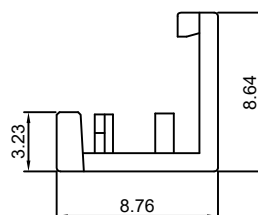

Ordering Information & Dimensions:

PART NO.	Dimensions	
	A	B
2P	2.54	5.08
3P	5.08	7.62
4P	7.62	10.16
5P	10.16	12.70
6P	12.70	15.24
7P	15.24	17.78
8P	17.78	20.32
9P	20.32	22.86
10P	22.86	25.40
11P	25.40	27.94
12P	27.94	30.48
13P	30.48	33.02
14P	33.02	35.56
15P	35.56	38.10
16P	38.10	40.64
17P	40.64	43.18
18P	43.18	45.72
19P	45.72	48.26
20P	48.26	50.80
21P	50.80	53.34
22P	53.34	55.88
23P	55.88	58.42
24P	58.42	60.96

Unit: mm