

### Specifications

- Current rating: 1A AC, DC
- Voltage rating: 30V AC, DC
- Temperature range: -25°C ~ +85°C
- Contact resistance: 30mΩ Max.
- Insulation resistance: 100MΩ Min.
- Withstanding voltage: 200V AC/minute
- \*Compliant with RoHS and REACH\*
- \*Meet the HF/Halogen Free, need to customize\*
- \*Contact HDGC for details\*

### Assembly layout

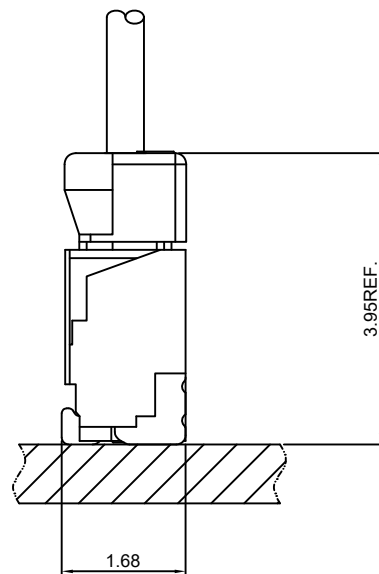

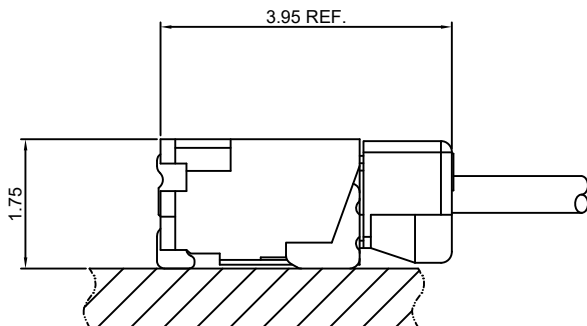

## HDGC0801 Series 0.80mm (.031") Pitch Wire to Board Connector

### HDGC0801-T

0.80mm pitch Crimp Terminal

**Reference Informations:**

\*Used in HDGC0801H-XP, HDGC0801H-XP-2 series Housing

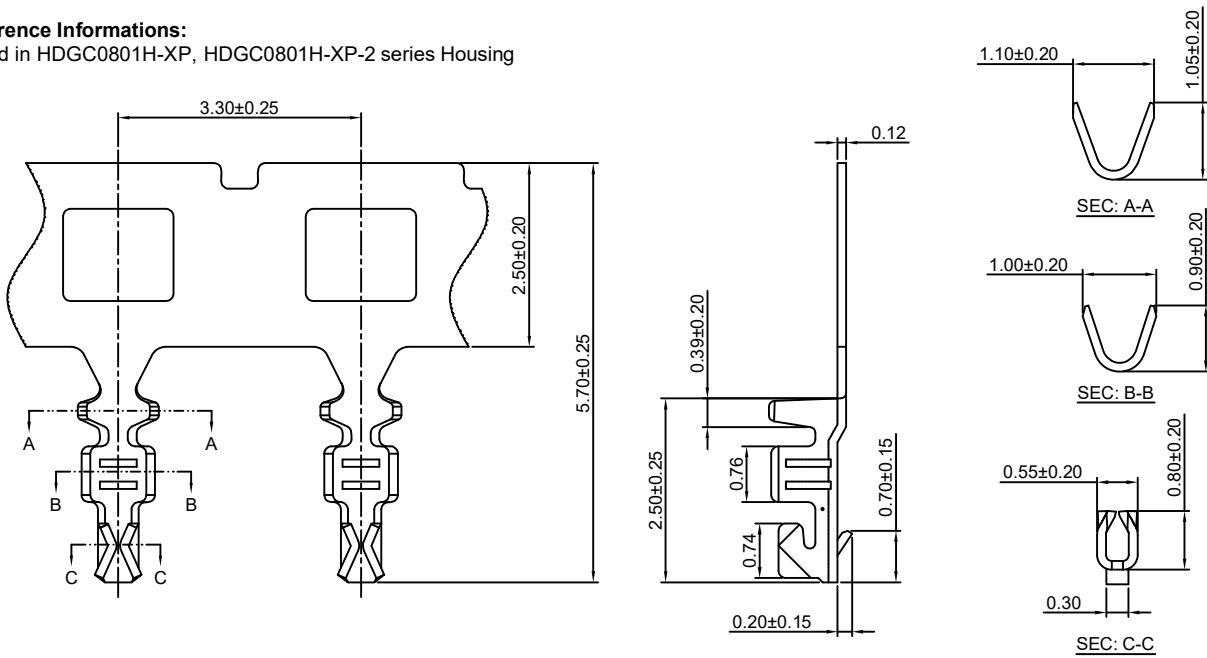

Ordering information & Specifications:

Unit:mm

Part NO.	Wire Range	Insulation O.D.	Material	Finish	Qty/reel
HDGC0801-TP	AWG#28-#32	0.60mm(max)	Phosphor Bronze	Tin over Nickel	45,000 PCS
HDGC0801-GP	AWG#28-#32	0.60mm(max)	Phosphor Bronze	Gold over flash	45,000 PCS

Optional Gold plating available but MOQ requested

### HDGC0801-T-A

0.80mm pitch Crimp Terminal

**Reference Informations:**

\*Used in HDGC0801HA-XP series Housing

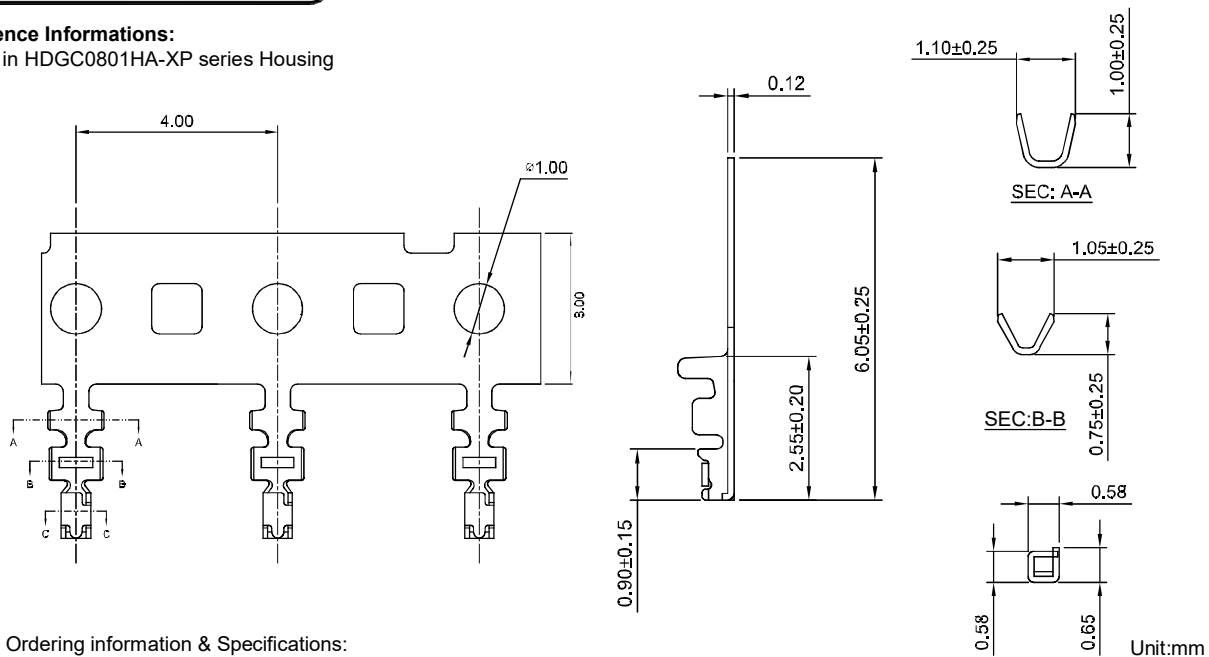

Ordering information & Specifications:

Unit:mm

Part NO.	Wire Range	Insulation O.D.	Material	Finish	Qty/reel
HDGC0801-TP-A	AWG #28-#32	0.60mm(max)	Phosphor Bronze	Tin over Nickel	30,000 PCS
HDGC0801-GP-A	AWG #28-#32	0.60mm(max)	Phosphor Bronze	Gold over flash	30,000 PCS

Optional Gold plating available but MOQ requested



## HDGC0801 Series 0.80mm (.031") Pitch Wire to Board Connector

### HDGC0801H-XP

0.80mm pitch Housing

**Reference Informations:**

- \*Material:LCP,UL94V-0
- \*Suitable HDGC0801-T series Terminal
- \*Mates with HDGC0802WV-S,WR-S-XP series Wafer
- \*Color:Natural

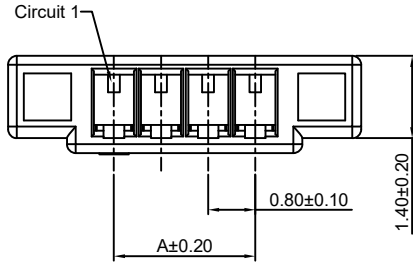

Ordering Information:  
HDGC0801H-XP - \*\*\*  
 $\frac{1}{2}$

- 1.Part No.
- 2.Material:  
 (Blank):LCP,UL94V-0  
 GWT:LCP,UL94V-0,GWT 750 °C

**Ordering Information & Dimensions:**

PART NO.	Dimensions	
	A	B
2P	0.80	2.40
3P	1.60	3.20
4P	2.40	4.00
5P	3.20	4.80
6P	4.00	5.60
7P	4.80	6.40
8P	5.60	7.20
9P	6.40	8.00
10P	7.20	8.80
11P	8.00	9.60
12P	8.80	10.40
13P	9.60	11.20
14P	10.40	12.00
15P	11.20	12.80
16P	12.00	13.60
17P	12.80	14.40
18P	13.60	15.20
19P	14.40	16.00
20P	15.20	16.80

Unit: mm

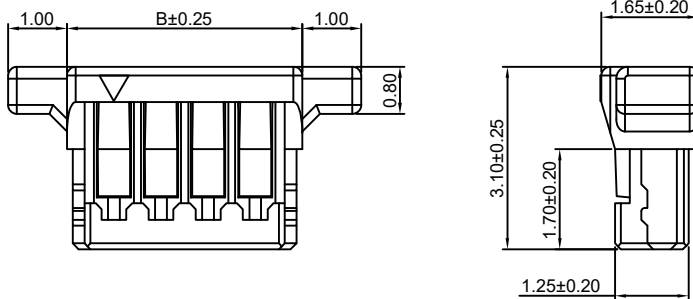

### HDGC0801H-XP-2

0.80mm pitch Housing

**Reference Informations:**

- \*Material:LCP,UL94V-0
- \*Suitable HDGC0801-T series Terminal
- \*Mates with HDGC0802WV-S,WR-S-XP series Wafer
- \*Color:Natural

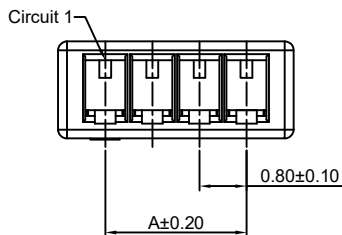

Ordering Information:  
HDGC0801H-XP-2 - \*\*\*  
 $\frac{1}{2}$

- 1.Part No.
- 2.Material:  
 (Blank):LCP,UL94V-0  
 GWT:LCP,UL94V-0,GWT 750 °C

PART NO.	Dimensions	
	A	B
2P	0.80	2.40
3P	1.60	3.20
4P	2.40	4.00
5P	3.20	4.80
6P	4.00	5.60
7P	4.80	6.40
8P	5.60	7.20
9P	6.40	8.00
10P	7.20	8.80
11P	8.00	9.60
12P	8.80	10.40
13P	9.60	11.20
14P	10.40	12.00
15P	11.20	12.80
16P	12.00	13.60
17P	12.80	14.40
18P	13.60	15.20
19P	14.40	16.00
20P	15.20	16.80

Unit: mm

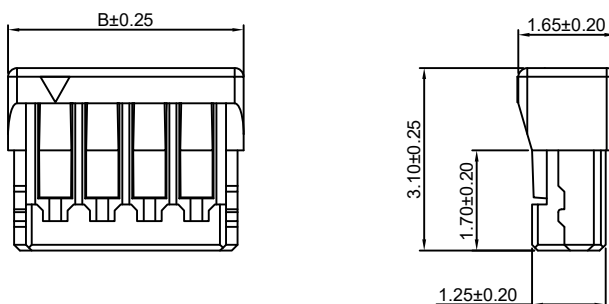



## HDGC0801 Series 0.80mm (.031") Pitch Wire to Board Connector

### HDGC0801HA-XP

0.80mm pitch Housing

#### Reference Informations:

\*Material:LCP,UL94V-0

\*Suitable HDGC0801-T series Terminal

\*Color:White

Ordering Information:  
HDGC0801HA-XP-\*\*\*

1 2

1.Part No.

2.Material:

(Blank):LCP,UL94V-0

GWT:LCP,UL94V-0,GWT 750 °C

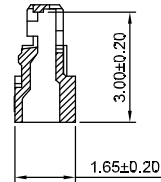
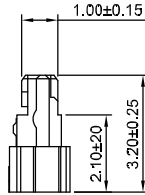
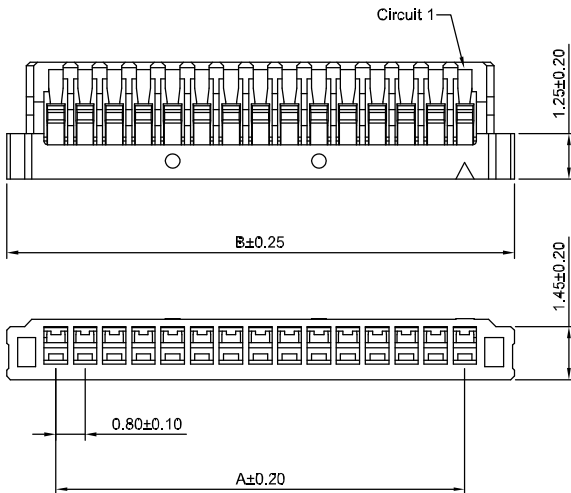
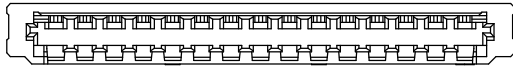

#### Ordering Information & Dimensions:

PART NO.	Dimensions	
	A	B
2P	0.80	3.50
3P	1.60	4.30
4P	2.40	5.10
5P	3.20	5.90
6P	4.00	6.70
7P	4.80	7.50
8P	5.60	8.30
9P	6.40	9.10
10P	7.20	9.90
11P	8.00	10.70
12P	8.80	11.50
13P	9.60	12.30
14P	10.40	13.10
15P	11.20	13.90
16P	12.00	14.70
17P	12.80	15.50
18P	13.60	16.30
19P	14.40	17.10
20P	15.20	17.90

Unit: mm